

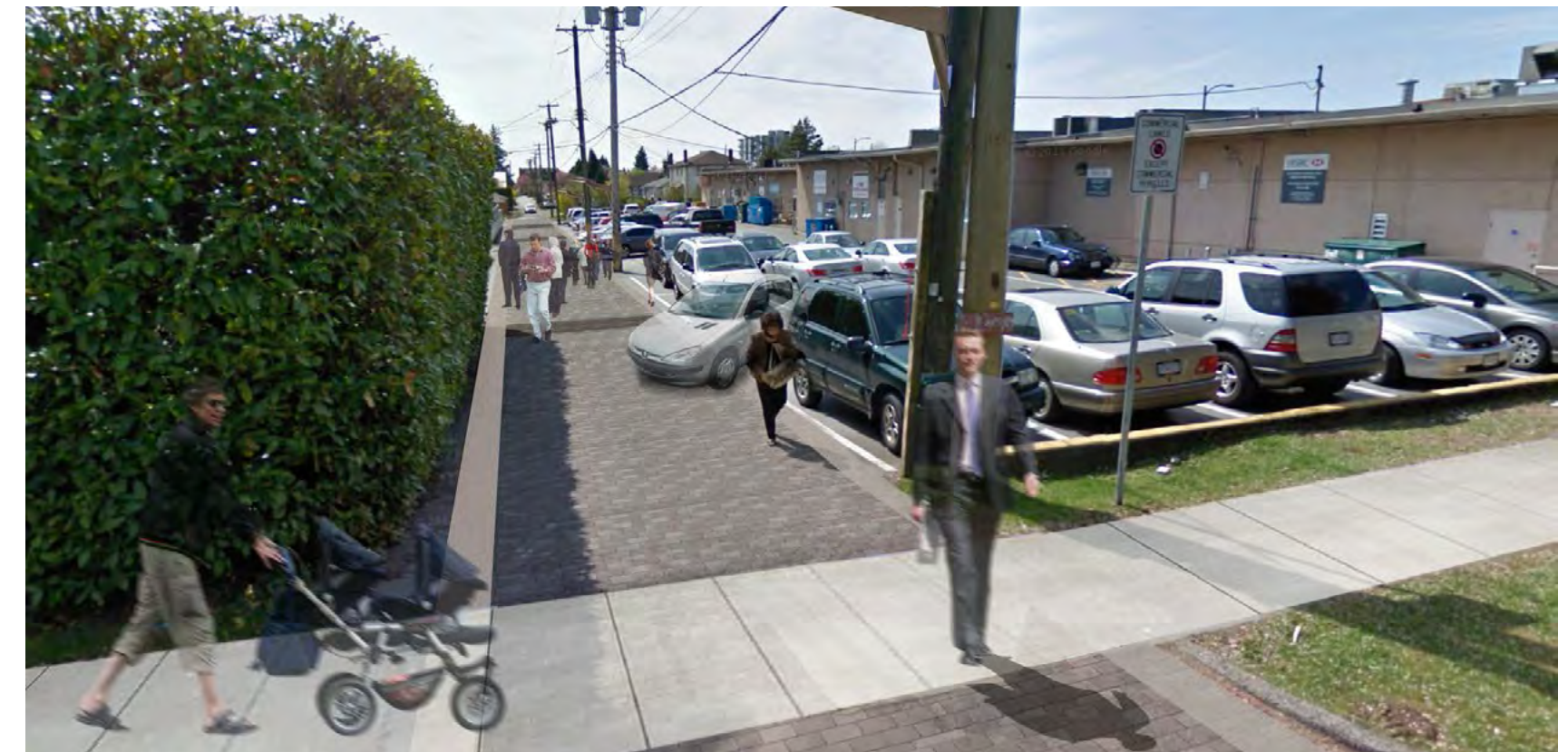

## CONNECTIVITY: PEDESTRIAN LINKS

**GOAL: CREATE AN INTERCONNECTED GREEN NETWORK, LINKING THE COMMUNITY WITH TRANSIT AND OTHER AMENITIES.**



Idea: Improved Lane

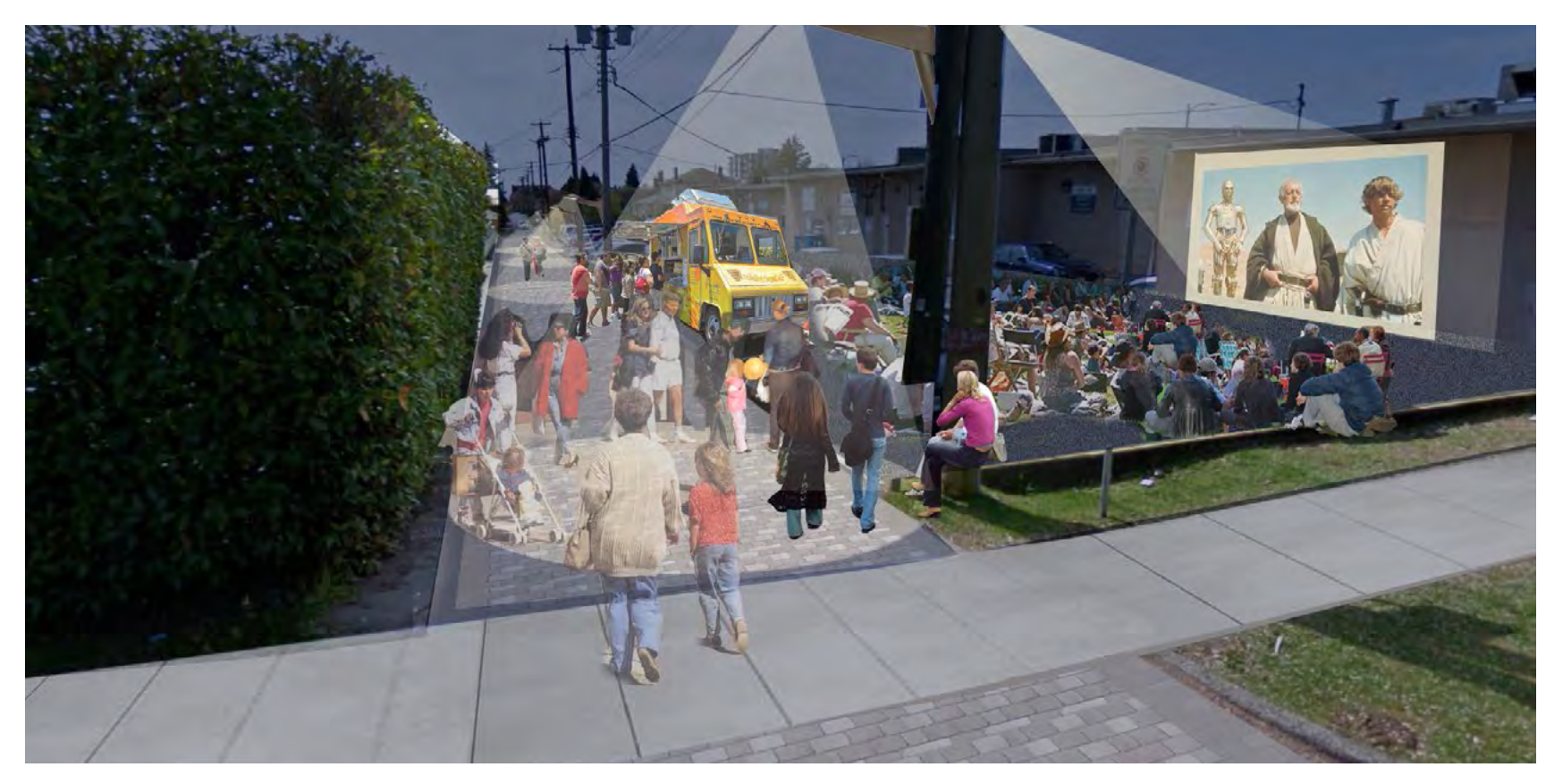

Idea: Mixed-use potential use at night

### Lanes: connectors and places

Recognizing that lanes serve a variety of functions, some lanes could be improved to enhance their function as important pedestrian links and secondary public spaces in the neighbourhood.

Ideas:

- Improved ground plane treatment, including exploration of increasing permeability in the lanes to increase stormwater infiltration
- Improved pedestrian scale lighting using existing infrastructure
- Improved edges with additional planting
- Mark key lanes with distinct entrance features

### Lanes: mixed use opportunities

Lanes within the first block off Cambie St. and associated with commercial uses could be activated in a variety of ways, including promoting secondary entries on the lane and community activities in off hours.

Ideas:

- Preserve existing mature trees in lanes when development occurs
- Buildings will activate the lane by providing active uses at the rear
- Recognizing the commercial functions of the lane, introduce improved ground plane treatments

### Parklets: Mid Block Pedestrian Links

When new development occurs, there are opportunities to introduce new neighbourhood connections. This is especially important in longer blocks. The intent is to introduce "Parklets" that provide these connections and reinforce the Green Network idea. These mini parks will help provide better connections (permeability) to key destinations,

including schools, public spaces, transit, neighborhood amenities, and neighbourhood businesses. They will also connect through the neighbourhood and to regional trails and other bicycle facilities

Two types of mid-block Parklets are proposed based on existing parcel sizes:



**Minor Parklet - 25' wide Example**  
**Role:** To provide connectivity and green space  
**Character:** Green connection  
**Public Space Elements:**

- Street furniture
- Lighting, public art
- Centered walkway, with places to stop
- Varied planting to encourage biodiversity

**Edge Conditions:**

- Possibility of private unit access from walkway
- Active facade of building facing open space

**Entry Features:**

- Wayfinding

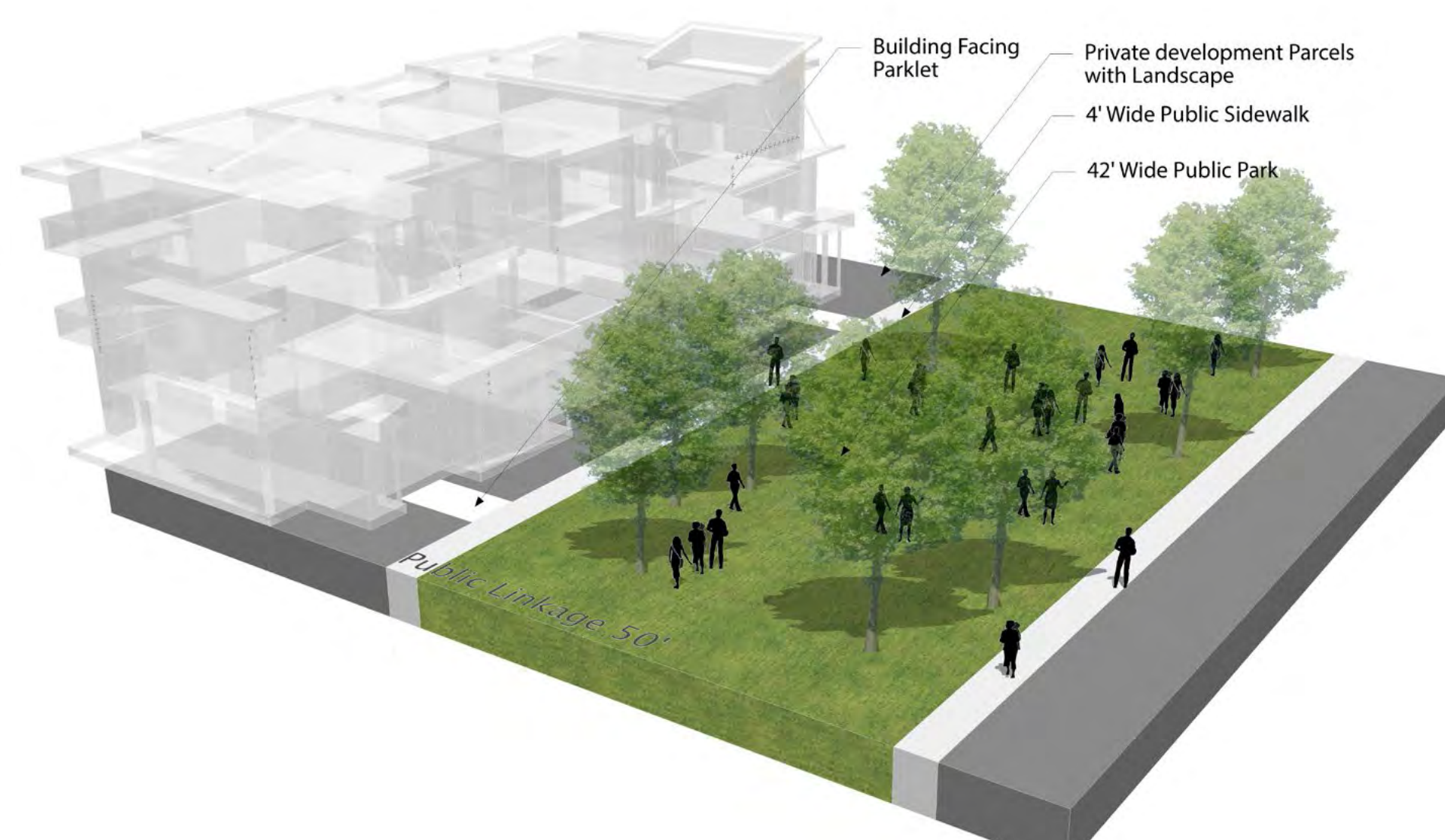

**Major Parklet: 50' wide Example**  
**Role:** To encourage social interaction as well as connectivity and green space where space permits  
**Character:** Pocket park-like feel  
**Public Space Elements:**

- Street furniture, lighting and public art
- Informal children's play potential
- Passive, quiet areas and open lawn
- Outdoor tables and spaces for interaction
- Varied planting for biodiversity, raingardens

**Edge Conditions:**

- Walkways along sides to allow easy access to units
- Active facade of building facing open space

**Entry Features:**

- Wayfinding and Public Art